

LEICESTERSHIRE COUNTY COUNCIL

**PUBLIC FOOTPATHS B14 (PART) AND B11 (PART),
IN THE PARISH OF TUR LANGTON**

PUBLIC PATH DIVERSION ORDER 2016

LEICESTERSHIRE COUNTY COUNCIL

SECTION 119 - HIGHWAYS ACT 1980

PUBLIC FOOTPATHS B14 AND B11 (PARTS),
IN THE PARISH OF TUR LANGTON

PUBLIC PATH DIVERSION ORDER 2016

This Order is made by Leicestershire County Council ("the authority") under Section 119 of the Highways Act 1980 (hereinafter called "the 1980 Act") because it appears to the authority that in the interests of the owners of the land crossed by the footpath and described in paragraph 1 of this Order it is expedient that the line of the footpath should be diverted.

The land owners have agreed to defray any compensation which becomes payable in consequence of the coming into force of this Order and any expenses which are incurred in bringing the new site of the footpath into a fit condition for use by the public.

Harborough District Council has been consulted as to the making of the Order as required by Section 120(2) of the 1980 Act.

BY THIS ORDER

1. The public right of way over the land situated at Tur Langton and shown by a bold continuous line on the map contained in this Order and described in Part 1 of the Schedule to this Order shall be stopped up after 30 days from the date of confirmation of this Order.

2. Notwithstanding anything contained in paragraph 1 where immediately before the date on which the public right of way referred to therein is diverted in pursuance of this Order, there is apparatus on, under or over the right of way belonging to statutory undertakers, for the purpose of carrying out their undertaking, the undertakers shall continue to have the same rights in respect of the apparatus as they then had.
3. There shall at the end of 30 days from the date of confirmation of this Order be a public footpath over the land at Tur Langton described in Part 2 of the Schedule shown by a bold broken line on the map contained in this Order.
4. Notwithstanding the provisions of paragraph 1 these provisions for the extinguishment of the public right of way shall not come into force until the Leicestershire County Council acting by its proper officer shall have certified that the agreed works have been carried out to its satisfaction in accordance with Section 119(3) of the 1980 Act.
5. The rights conferred on the public under this Order shall be subject to the limitations and conditions set out in Part 3 of the Schedule
6. This Order may be cited as the "Leicestershire County Council (Diversion of Public Footpath B14 (Part) and B11 (Part), in the parish of Tur Langton) Order 2016."

SCHEDULE

PART 1

Description of Site of Existing Footpath B14 (Part) at Tur Langton to be Diverted

That part of Public Footpath B14 in the Parish of Tur Langton and the District of Harborough, shown by a bold continuous line on Plan No. 2352 annexed hereto, which extends from point "B" on the plan, situate at Grid Reference 47130 29472 in generally westerly and west-north westerly directions for a total distance of approximately 110 metres, to point "C" on the plan, situate at Grid Reference 47120 29474. (B-C as indicated on the plan)

This section of footpath to be diverted has no recorded width.

PART II

Description of Site of New Footpath B14 (Part) at Tur Langton

A new footpath (B14) in the Parish of Tur Langton and the District of Harborough, shown by a bold broken line on Plan No. 2352 annexed hereto, which extends from point "B" on the plan, situate at Grid Reference 47130 29472, in a generally westerly direction along a grassy track, for a total distance of approximately 110 metres to point "D" on the plan situate at its junction with existing Footpath B11, at Grid Reference 47120 29472. (B-D as indicated on the plans)

The new footpath will have a width of 2 metres.

PART III

Description of Site of Existing Footpath B11 (Part) at Tur Langton to be Diverted

That part of Public Footpath B11 in the Parish of Tur Langton and the District of Harborough, shown by a bold continuous line on Plan No. 2352 annexed hereto, which extends from point "E" on the plan, situate at Grid Reference 47119 29472 in generally north-north westerly direction, passing through an old silo, for a total distance of approximately 20 metres, to point "A" on the plan, situate at Grid Reference 47119 29474. (E-A as indicated on the plan)

This section of footpath to be diverted has no recorded width.

PART IV

Description of Site of New Footpath B11 (Part) at Tur Langton

A new footpath (B11) in the Parish of Tur Langton and the District of Harborough, shown by a bold broken line on Plan No. 2352 annexed hereto, which extends from point "E" on the plan, situate at Grid Reference 47119 29472, in a generally east north easterly direction, for a total distance of approximately 15 metres to point "C" on the plan situate at its junction with existing Footpath B14, at Grid Reference 47120 29474. (E-C as indicated on the plans)

The new footpath will have a width of 2 metres.

PART V

LIMITATIONS AND CONDITIONS

None

THE COMMON SEAL of THE LEICESTERSHIRE)
COUNTY COUNCIL was hereunto affixed)
this seventh day of January 2016)
in the presence of:)

Authorised Officer





32273

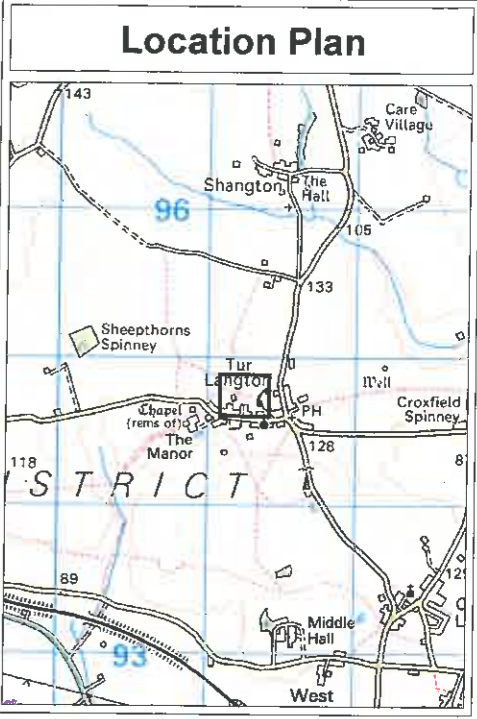
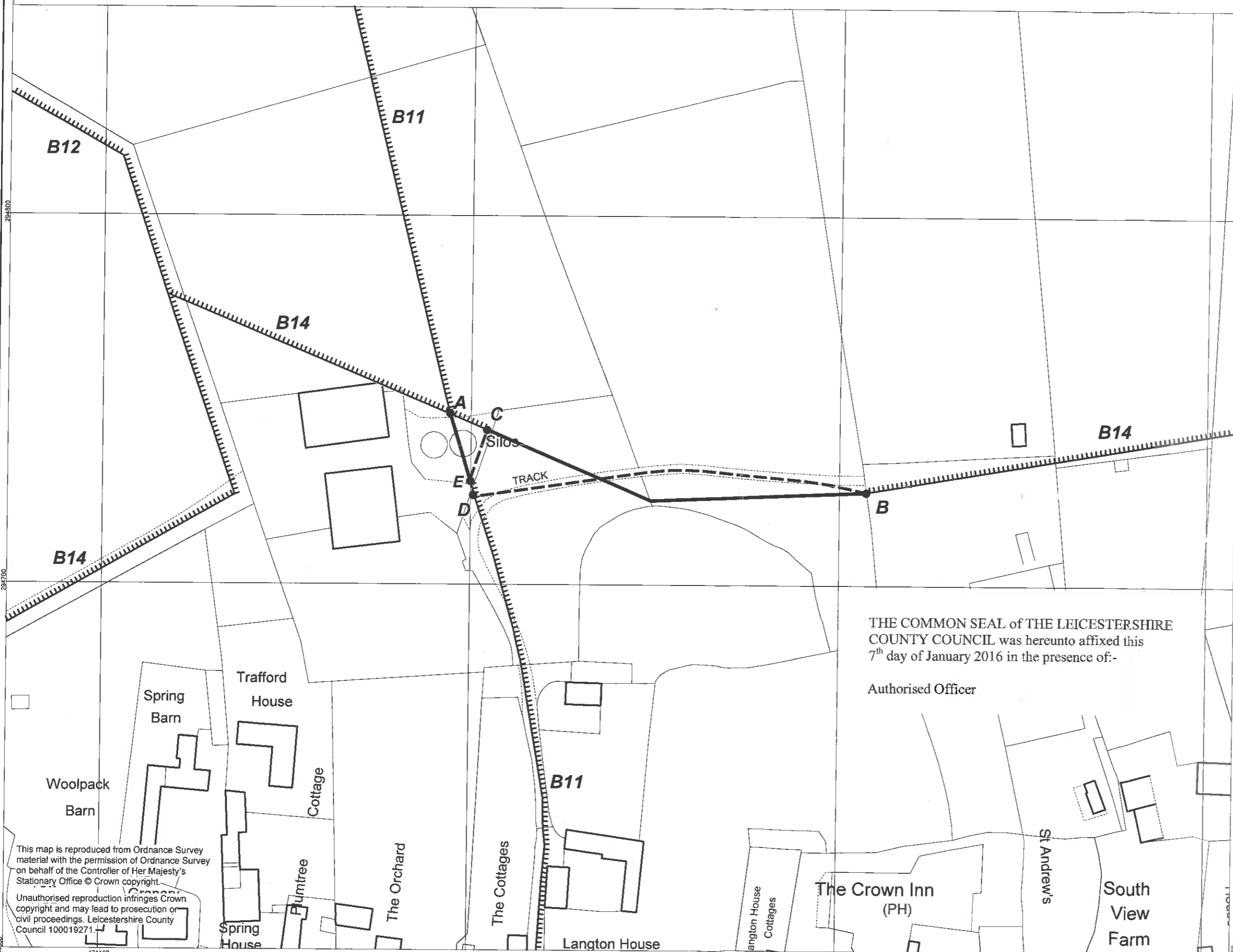

Leicestershire County Council - Diversion of Public Footpath B14 (Part) and B11 (Part) in the Parish of Tur Langton - Public Path Diversion Order 2016



- Key**
-  Footpaths to be diverted
B-C & E-A
 -  Alternative new paths
B-D & E-C
 -  Footpaths unaffected

THE COMMON SEAL of THE LEICESTERSHIRE COUNTY COUNCIL was hereunto affixed this 7th day of January 2016 in the presence of:-

Authorised Officer

32273(a)



Authorised Officer

This map is reproduced from Ordnance Survey material with the permission of Ordnance Survey on behalf of the Controller of Her Majesty's Stationary Office © Crown copyright.
 Unauthorised reproduction infringes Crown copyright and may lead to prosecution or civil proceedings. Leicestershire County Council 100019271.

Environment & Transport Department,
 County Hall, Glenfield,
 Leicestershire LE3 8RJ
 email footpaths@leics.gov.uk
 Phil Crossland, Director



Plan No. 2352
 Scale 1:1000